

AMERICAN AVK RESILIENT SEATED GATE VALVE
250 PSI, Tested to AWWA C509 (NRS)
ANSI B16.1 Class 125 Flanged x Flanged Ends - Valve Sizes 2"

25/4X
FLxFL

Use:
 For water and neutral liquids to maximum 160°F.

Tests:
 Hydraulic test to AWWA C509:
 Shell Test: 500 PSI
 Seat Test: 250 PSI
 Operating Torque Test

Optional Materials:

Handwheel

Standard Materials:	
Body	Cast iron ASTM A126 class B
Bonnet, Gland Flange	Ductile iron ASTM A536
Coating	Electrostatically applied fusion-bonded epoxy-resin Meets or exceeds AWWA C550
Wrench Nut	Ductile iron ASTM A536 - painted black for open left, red for open right.
Stem	Standard: Stainless Steel, ASTM A582
Wedge	Ductile iron ASTM A536 encapsulated with EPDM-rubber compound
Wedge Nut, Thrust Collar	Bronze
Bonnet Bolts	Stainless Steel - 316 sealed with hot melt
Gland Bolts	Stainless Steel - 316 Hexagon bolt
Bonnet Gasket Wiper Ring, O-Ring Stem Seals, O-Ring Gland Seal	ASTM D2000 Buna "N" nitrile rubber

Approvals:

Certified to: NSF/ANSI 61, NSF/ANSI 372



Certified to
NSF/ANSI 61



Certified to
NSF/ANSI 372

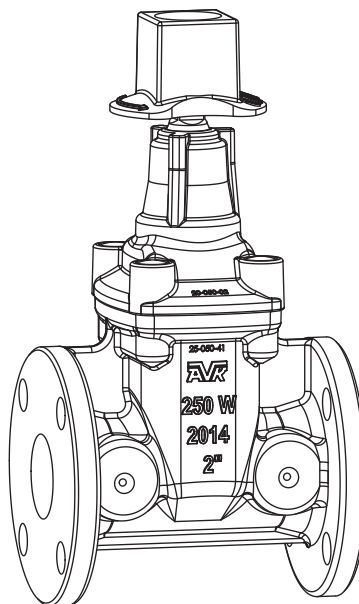

AMERICAN AVK RESILIENT SEATED GATE VALVE
250 PSI, Tested to AWWA C509 (NRS)
ANSI B16.1 Class 125 Flanged x Flanged Ends - Valve Sizes 2"

25/4X
FLxFL

Component List:

- | | | |
|------------------|-------------------|----------------------------------|
| 1. Body | 7. Bonnet | 13. Wiper Ring |
| 2. Wedgw Core | 8. Stem Seal | 14. Wrench Nut |
| 3. Wedge Rubber | 9. Thrust Collar | 15. Wrench Nut Washer |
| 4. Wedge Nut | 10. O-Rings | 16. Wrench Nut Bolt |
| 5. Stem | 11. Slide Bearing | 17. Bonnet Bolt |
| 6. Bonnet Gasket | 12. O-Rings | 18. Bonnet Bolt Seals (Hot Melt) |

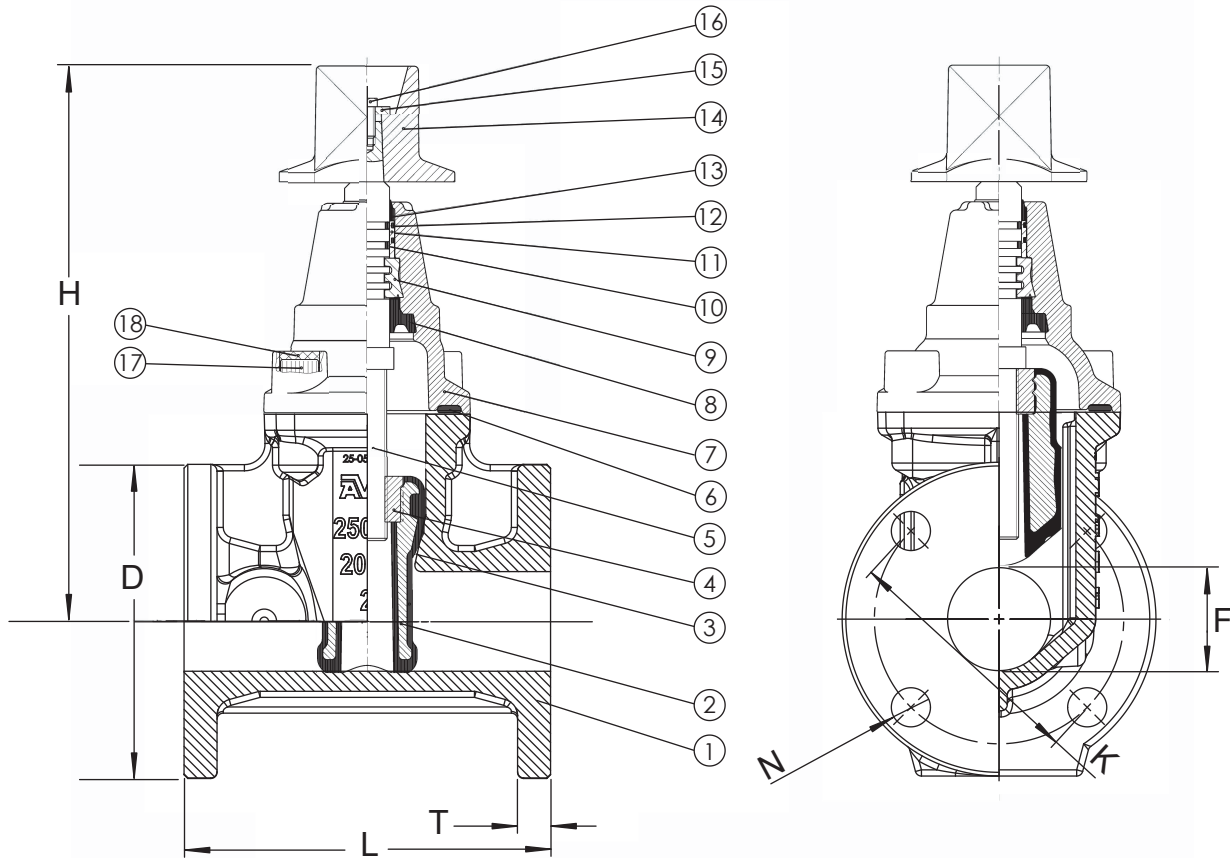

Ref No.	Size	D	F	H	K	L	N	T	Flange Holes	Turns to Open	Wt. Lbs.
25-050-4X	2"	6.00"	2.00"	10.56"	4.75"	7.00"	0.75"	0.63	4	11	29

