

# AMERICAN AVK RESILIENT SEATED DUCTILE IRON GATE VALVE

45/PFP-UL

Tested to AWWA C509 / C515 (NRS) for Indicator Post

POxFL PIV

Push-on Joint End (TYTON®) x Flanged End to ANSI B16.1 Class 125 - Valve sizes 4" - 12" & 16"

**Use:**

For water and neutral liquids to maximum 160°F.

**Tests:**

Hydraulic test to AWWA C509 & UL 262:

Shell Test: 500 PSI 4"-16"

Seat Test: 375 PSI 4"-12" - 300 PSI -16"

Operating Torque Test

**Optional Materials:**

Stem For UL, FM, ULC for 4" - 12"  
Low Zinc Bronze ASTM B763

Anti Friction Washers Polyamide

Wedge Ductile iron ASTM A536  
encapsulated with NBR-rubber  
compound

**Standard Materials:**

Body, Bonnet,  
Post Indicator Plate,  
Wrench Nut

Ductile iron ASTM A536  
(Wrench Nut-painted black for  
open left, red for open right)

**Coating**

Electrostatically applied fusion-  
bonded epoxy-resin  
Meets or exceeds AWWA C550

**Stem**

Stainless steel 304, 4"-12"  
Aluminum Bronze C63020, 14"-16"

**Wedge**

Ductile iron ASTM A536  
encapsulated with EPDM-rubber  
compound

Wedge Nut, Thrust Collar Bronze

Bonnet Bolts Stainless Steel - 316  
sealed with hot melt

Gland Bolts Stainless Steel - 316  
Hexagon bolt

Bonnet Gasket,  
Wiper Ring,  
O-Ring Stem Seals,  
O-Ring Gland Seal  
ASTM D2000 Buna "N" nitrile  
rubber

**Approvals:**



\*UL/ULC Listed  
\*FM Approved  
Certified to: ANSI/NSF 61, ANSI/NSF 372

Certified to  
NSF/ANSI 61

Certified to  
NSF/ANSI 372

\* Approved at 250 PSI working pressure, 4"-12"  
\* Approved at 200 PSI working pressure, 16"

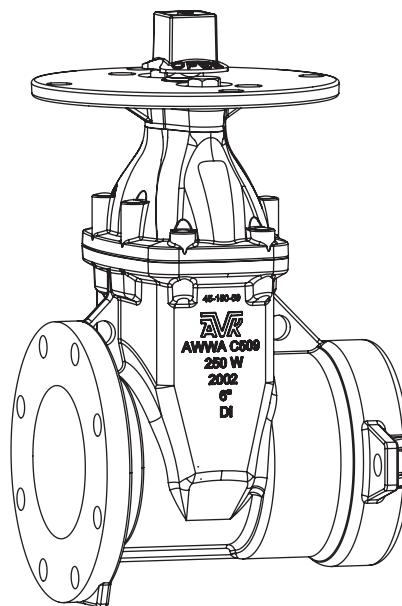

# AMERICAN AVK RESILIENT SEATED DUCTILE IRON GATE VALVE

Tested to AWWA C509 / C515 (NRS) for Indicator Post

Push-on Joint End (TYTON®) x Flanged End to ASME B16.42 Class 150 - Valve sizes 4" - 12" & 16"

45/PFP-UL  
POxFL PIV

**Component List:**

- |                           |                              |                             |
|---------------------------|------------------------------|-----------------------------|
| 217. Bonnet               | 226. Wiper Ring              | 232. Lower Stem Seal O-Ring |
| 218. Bonnet Gasket        | 227. Gland Flange Bolt       | 233. NRS Stem               |
| 219. Body                 | 229. Gland O-Ring            | 234. Thrust Collar          |
| 224. Post Indicator Plate | 230. Upper Stem Seal O-Rings | 237. Wedge                  |
| 225. Wrench Nut           | 231. Stem Seal Bushing       |                             |

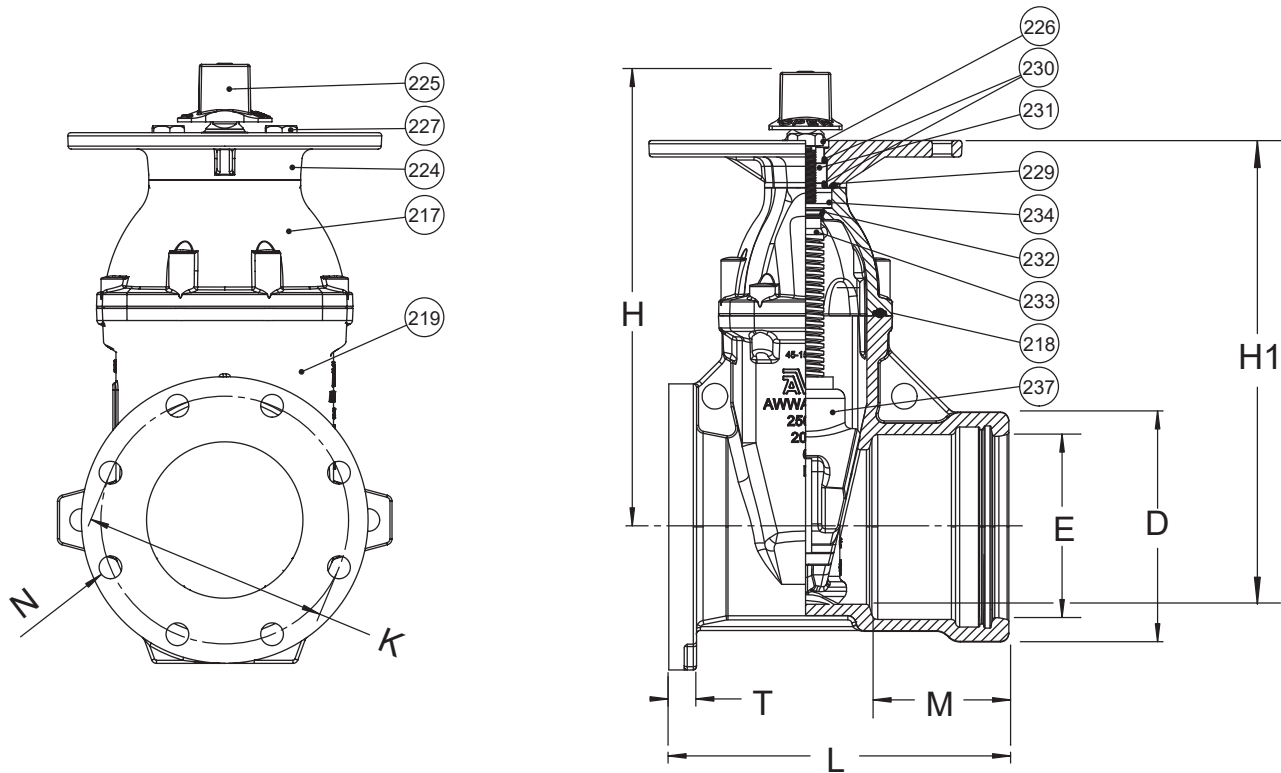

Ref No.	Size	D	E	H	H1	K	L	M	N	T	Holes	Flange to Open	Turns (lbs.)	Weight
45-100-PFP	4"	6.66"	4.93"	13.50"	13.00"	7.50"	10.51"	4.12"	0.75"	1.00"	8	14	95	
45-150-PFP	6"	8.84"	7.03"	17.50"	18.00"	9.50"	13.07"	5.22"	0.88"	1.06"	8	21	134	
45-200-PFP	8"	11.23"	9.18"	21.50"	23.00"	11.75"	14.33"	5.63"	0.88"	1.14"	8	26	190	
45-250-PFP	10"	13.50"	11.22"	24.75"	27.00"	14.25"	15.31"	5.63"	1.00"	1.22"	12	32	268	
45-300-PFP	12"	15.74"	13.32"	27.75"	31.00"	17.00"	16.61"	5.63"	1.00"	1.30"	12	38	394	
45-400-PFP	16"	20.62"	17.51"	35.47"	42.00"	21.25"	19.35"	5.00"	1.13"	1.44"	12	51	836	

